

CENTRAL EXT.

TOUHY (7200 N)

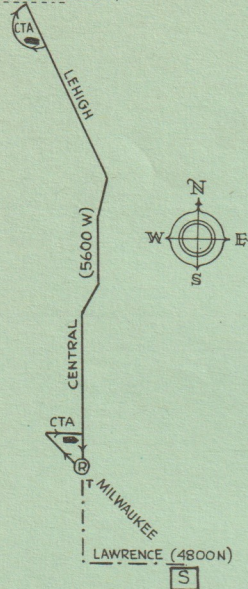

NORTH CICERO

GLENLAKE (6100 N)

PETERSON (6000 N)

KEATING (4732 W)

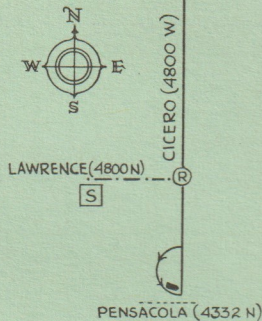

BELL and HOWELL

BELL & HOWELL

TOUHY (7200 N)

M'CORMICK (3300 W)

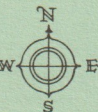

DEVON (6900 N)

PETERSON (6000 N)

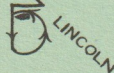

Chicago Transit Authority
TRAINING DEPARTMENT

AS 248, REV. 11-52

Route Maps LAWRENCE STATION

Ⓡ RELIEF POINT

Ⓣ TELEPHONE

Ⓢ STATION

➡ LAYOVER

----- PULL OUT - PULL IN ROUTE

NOTE: ROUTES NOT DRAWN TO SCALE

CENTRAL

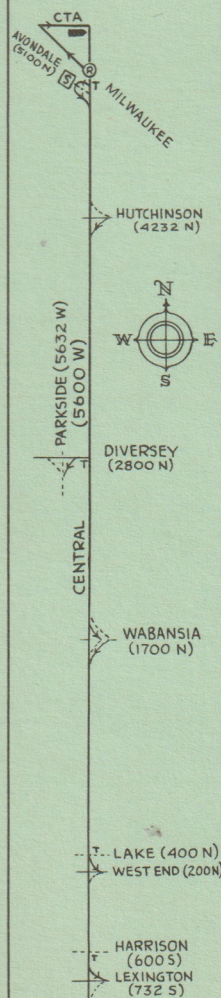

HARLEM

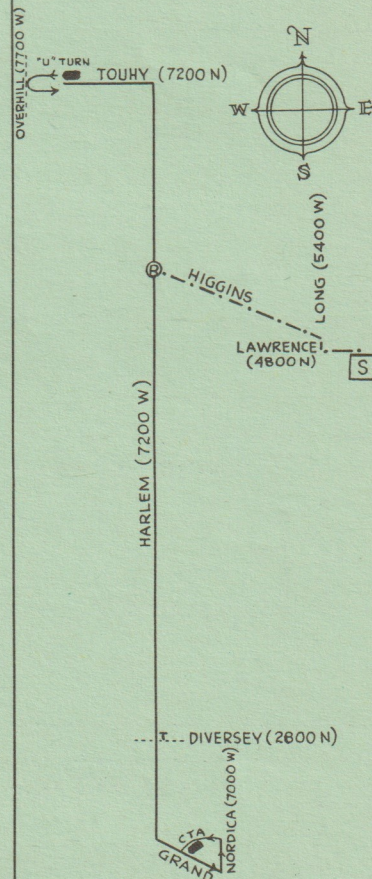

LAWRENCE

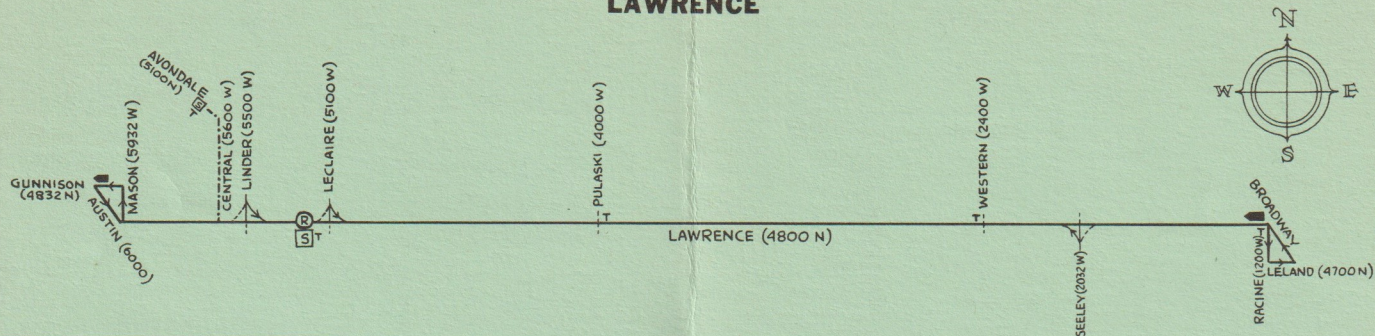

MONTROSE

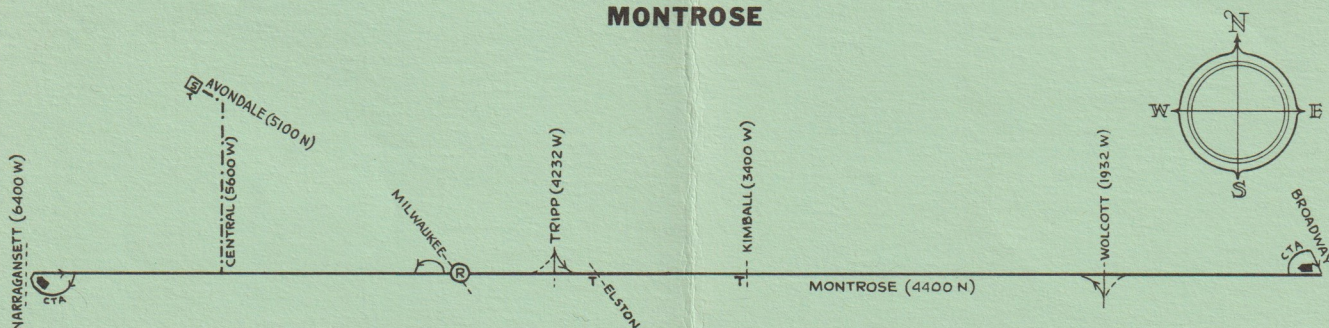

IRVING PK. EXT.

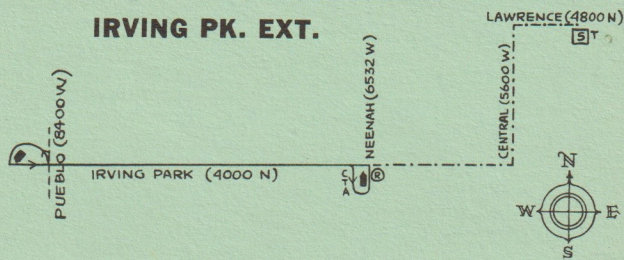

WEST FOSTER

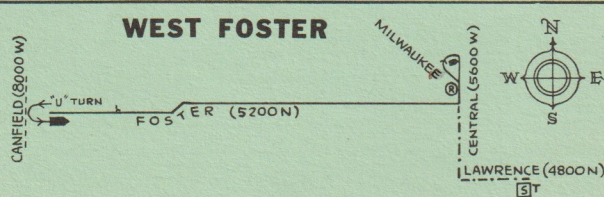

HIGGINS

