

KEY

- INDICATES CTA PRIVATE PROPERTY SIGN
- TROLLEY POLE
- WITH LIGHT CITY POLE WITH LIGHT
- BELL TEL CO POLE

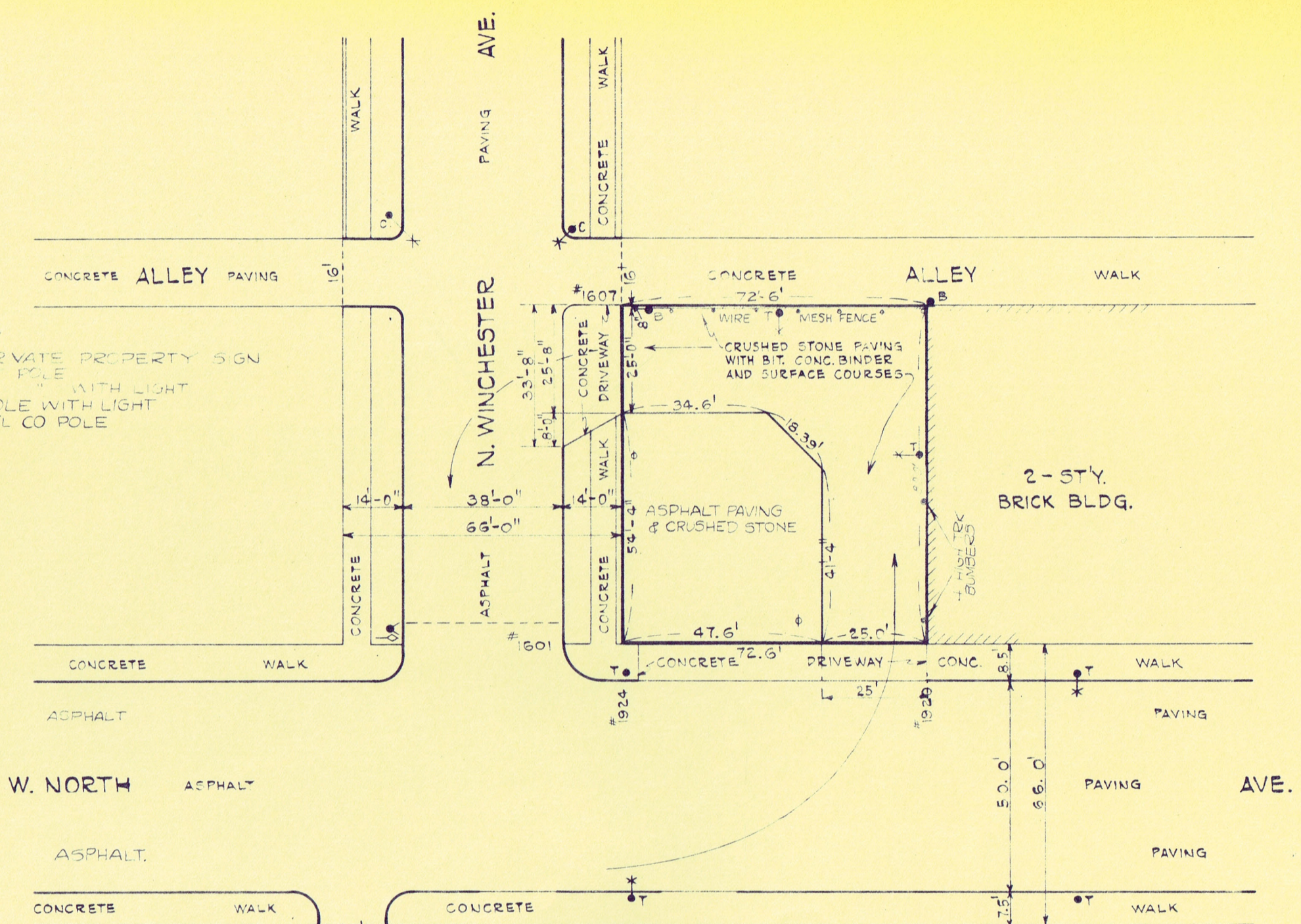

REVISED AS OF OCT 27, 1958

CHICAGO TRANSIT AUTHORITY DEPARTMENT OF WAY AND STRUCTURES P	
PROPERTY	
TROLLEY BUS TERMINAL	
W. NORTH AVE. & N. WINCHESTER AVE.	
Dr. by F.E.K. Ch. by O.K.T. <i>Spangenberg</i> Chief Draftsman	Approved <u>4/9/1950</u> <i>N. ...</i> Gen. Supt. of Way & Structures
Approved _____	Scale 1" = 30'-0"
Approved _____	Date AUG. 16, 1950
Approved <u>Apr. 19 1950</u> <i>M. Busch</i> Supt. of Bldgs. & Drafting	DRG. No. 2-P-37

X