

FOREST PRESERVE DISTRICT
COOK COUNTY

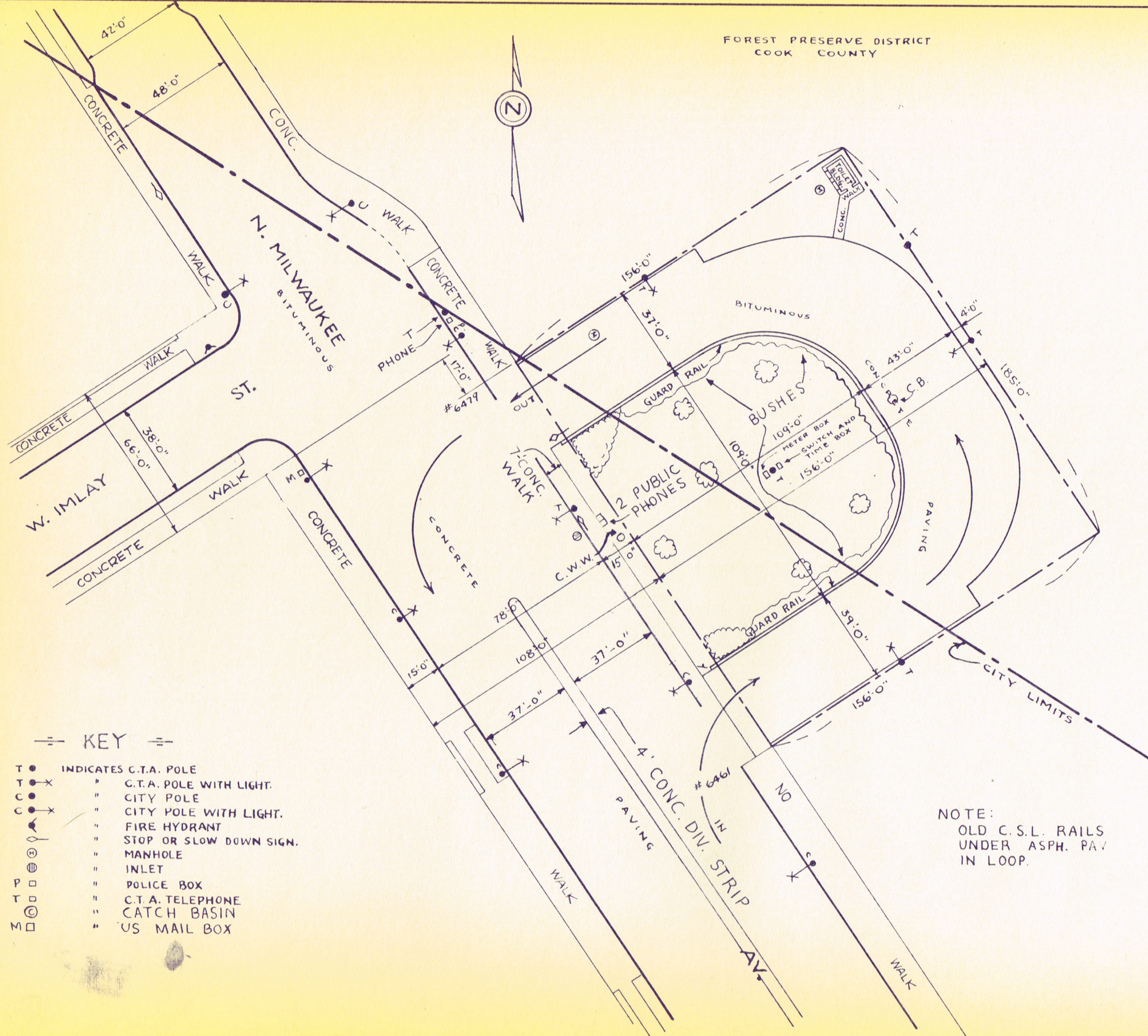

- == KEY ==
- T ● INDICATES C.T.A. POLE
 - T ● X " C.T.A. POLE WITH LIGHT.
 - C ● " CITY POLE
 - C ● X " CITY POLE WITH LIGHT.
 - " FIRE HYDRANT
 - ⊕ " STOP OR SLOW DOWN SIGN.
 - ⊙ " MANHOLE
 - ⊙ " INLET
 - P □ " POLICE BOX
 - T □ " C.T.A. TELEPHONE
 - ⊙ " CATCH BASIN
 - M □ " US MAIL BOX

NOTE:
OLD C.S.L. RAILS
UNDER ASPH. PAV
IN LOOP.

REVISED MARCH 2, 1965
REVISED JUNE 24, 1964 GLP. *CCR*
SUPERSEDES DRG. NO. 2-P-849, DATED NOV. 25, 1927

CHICAGO TRANSIT AUTHORITY	
ENGINEERING DEPARTMENT	
LEASED PROPERTY	
BUS TERMINAL	
N. MILWAUKEE AV. & W. IMLAY ST. - FOREST PRESERVE	
DRAWN <u>D.F. BRUNOD</u>	APPROVED _____
CHECKED _____	GEN. SUPT. OF ENGINEERING
CORRECT _____	SCALE 1" = 40'
APPROVED _____	DATE APRIL 13, 1960.
APPROVED _____	DRG. NO. 2-P-849
ENG. OF BLDGS. & STRUCTURES	