

VILLAGE OF LINCOLNWOOD

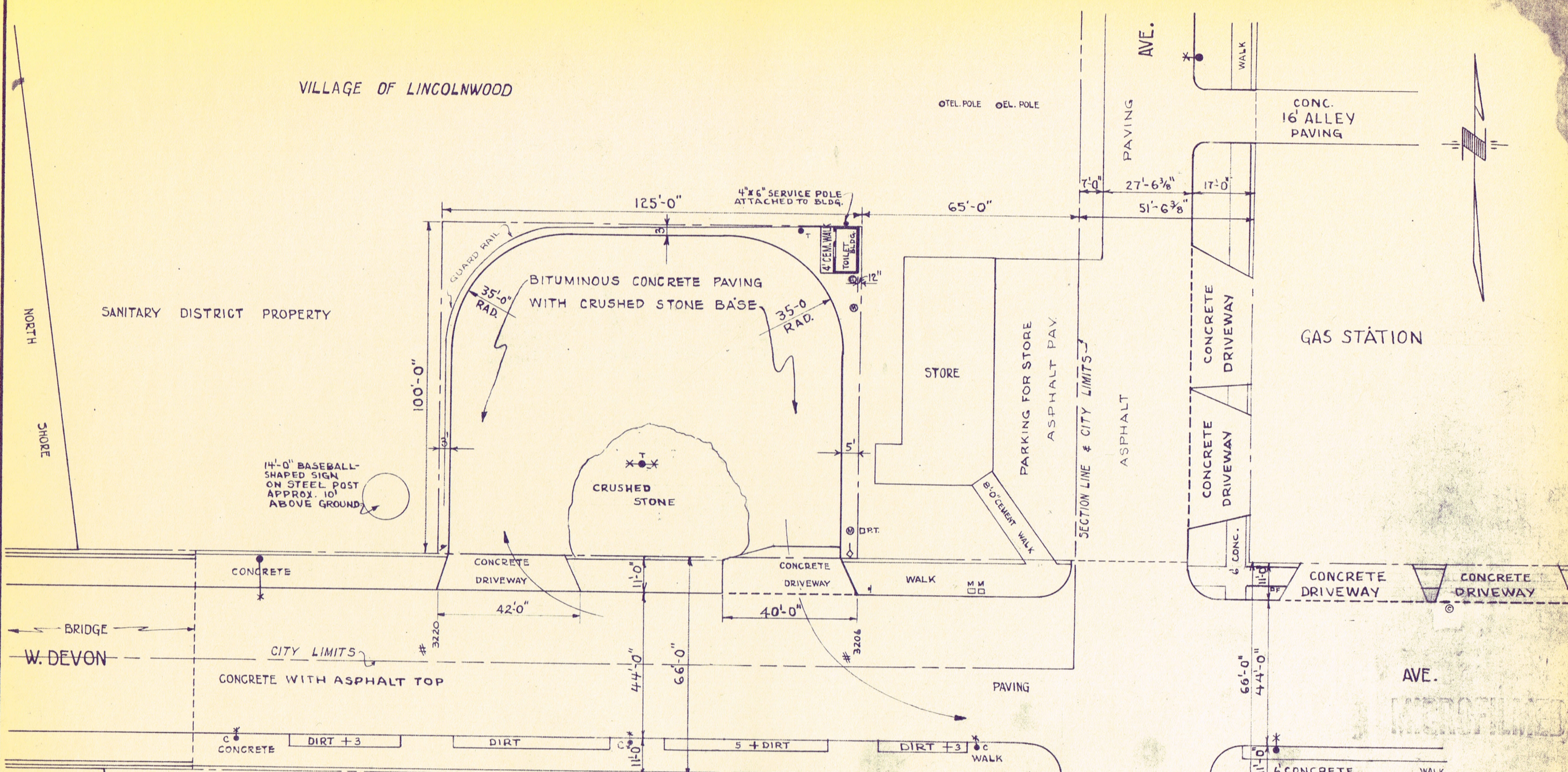

KEY

- T • C.T.A. POLE
- T • X " WITH LIGHT
- C • CITY POLE
- C • X CITY POLE WITH LIGHT
- ⊙ MANHOLE
- ⊙ CATCH BASIN
- + 10 TREE (FIG. INDICATES DIA. IN INCHES)
- RT. □ PUBLIC TELEPHONE
- ↑ "AUTOS KEEP OUT" SIGN
- STOP SIGN
- U.S. MAIL BOX
- FIRE ALARM BOX

CITY OF CHICAGO

REVISED FEB 8, 1960 REVISED JUNE 24, 1964 RCM

CHICAGO TRANSIT AUTHORITY
 DEPARTMENT OF WAY AND STRUCTURES

LEASED PROPERTY

BUS TERMINAL

NORTHWEST CORNER - N. KEDZIE AV. & W. DEVON AV.

Dr. by <i>L. L. Ch.</i>	Ch. by <i>7/19/50</i>
O.K. <i>P. Spangmasher</i>	Approved <i>[Signature]</i>
Chief Draftsman	Gen. Supt. of Way & Structures
Correct	Scale 1" = 30'-0"
Correct	Date AUG. 9, 1948
Approved <i>[Signature]</i>	Supt. of Bldgs. & Drafting

DRG. No 2-P-12