

VILLAGE OF LINCOLNWOOD

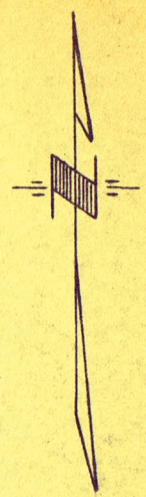
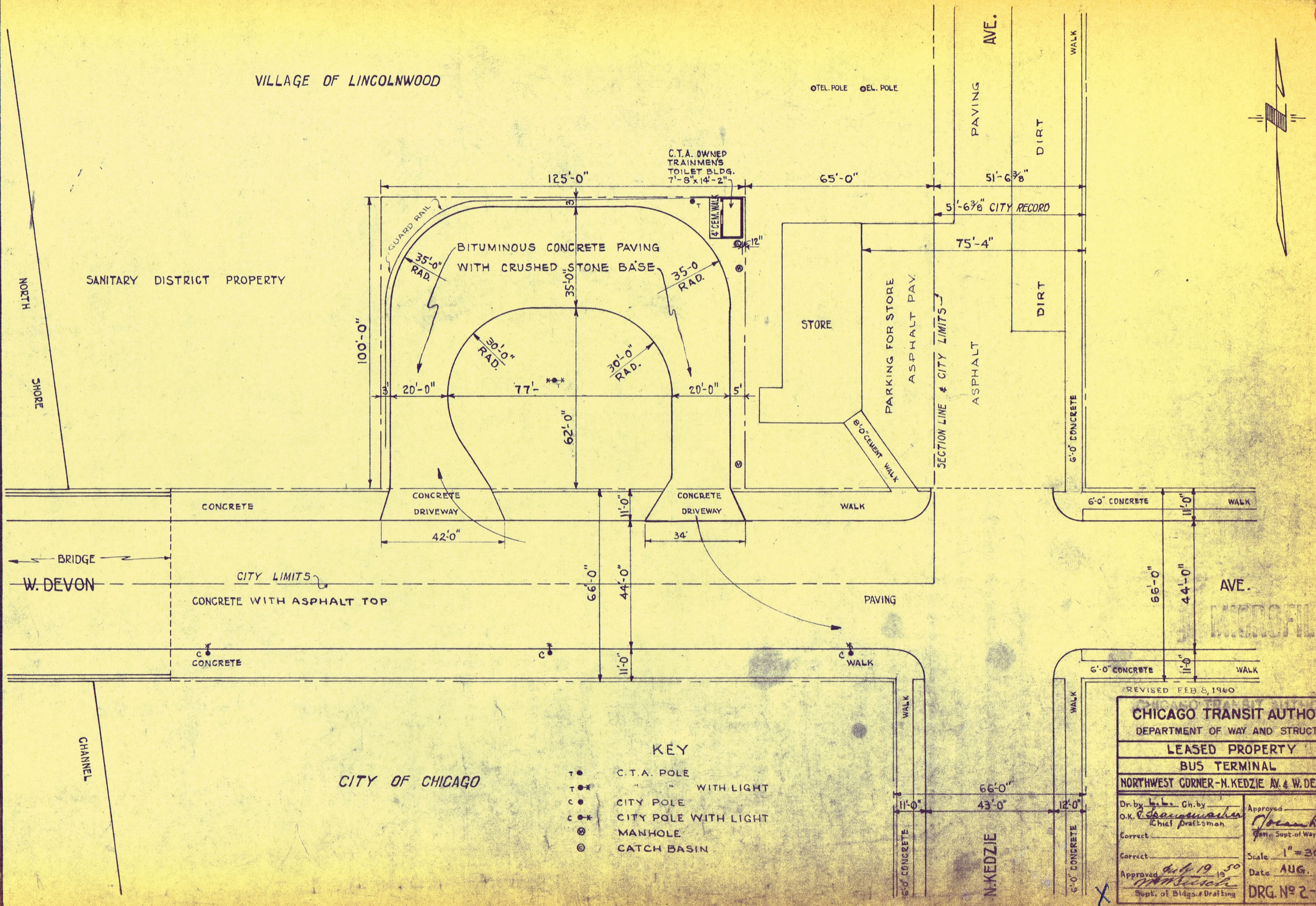

KEY

- T • C.T.A. POLE
- T • x " " WITH LIGHT
- C • CITY POLE
- C • x CITY POLE WITH LIGHT
- ⊙ MANHOLE
- ⊙ CATCH BASIN

CITY OF CHICAGO

REVISED FEB 8, 1960

CHICAGO TRANSIT AUTHORITY
DEPARTMENT OF WAY AND STRUCTURES

LEASED PROPERTY
BUS TERMINAL

NORTHWEST CORNER - N. KEDZIE AV. & W. DEVON AV.

Dr. by <i>W. L. ...</i> Ch. by <i>...</i>	Approved <i>7/19/50</i>
O.K. <i>...</i> Chief Draftsman	Gen. Supt. of Way & Structures
Correct	Scale 1" = 30'-0"
Correct	Date AUG. 9, 1948
Approved <i>...</i> 19 50	DRG. No 2-P-12
Supt. of Bldgs. & Drafting	